



A  
P  
-  
P  
P  
N

*ASIA-PACIFIC PUBLIC POLICY NETWORK (AP-PPN)  
CONFERENCE 2017*

**PUBLIC POLICY IN ASIA - PACIFIC: CONTEMPORARY TRENDS**

**10-11 FEBRUARY 2017**  
**CHIANG MAI, THAILAND**

**UNISERV, CHIANG MAI UNIVERSITY**

# Conference Program

## AP-PPN Conference 2017

February 10-11, 2017 at UNISERV, Chiang Mai University, Chiang Mai, Thailand

### Friday, February 10, 2017

Time	Schedule	Venue
08.30-08.45	<b>Registration</b>	
08.45-09.00	<b>Welcome and Introduction</b> Ora-orn Poocharoen   <i>Chiang Mai University</i>	Room 1 – Inthanin, 1 <sup>st</sup> Flr.
09.00-10.00	<b>Opening Keynote Address</b> <b>Public Policy Education in Southeast Asia: Convergence, Divergence and Dissonance</b> Darryl Jarvis   <i>the Education University of Hong Kong</i>	Room 1 - Inthanin, 1 <sup>st</sup> Flr.
10.00-10.30	Coffee Break & Networking	1 <sup>st</sup> Flr.
	<b>Panel Session I</b>	
10.30-12.30	Trends in Public Administration: Justice, Leadership, Collaboration and Good Governance	Room 1 - Inthanin, 1 <sup>st</sup> Flr.
	International Relations and Foreign Policy in East Asia: Trans-Boundary Issues	Room 2 - Fai Kham, 1 <sup>st</sup> Flr.
12.30-13.30	Lunch	1 <sup>st</sup> Flr.
13.30-15.00	<b>Plenary: Policy Education in the Asia-Pacific and PhD programmes in Public Policy Schools</b> Chair: Heng Yee Kuang   <i>University of Tokyo</i> Hideaki Shiroyama   <i>University of Tokyo</i> Michael Howlett   <i>National University of Singapore</i> Zhilin Liu   <i>Tsinghua University</i> Ora-orn Poocharoen   <i>Chiang Mai University</i>	Room 1 - Inthanin, 1 <sup>st</sup> Flr.
15.00-15.30	Coffee Break & Networking	1 <sup>st</sup> Flr.
	<b>Panel Session II</b>	
15.30-17.30	Environmental Policy in Asia: Evaluation and Improvements	Room 1 - Inthanin, 1 <sup>st</sup> Flr.
	Local Governance (I): Networks and Collaboration	Room 2 - Fai Kham, 1 <sup>st</sup> Flr.
	Business and Policy	Room 3 – Bua Thong, 1 <sup>st</sup> Flr.
18.00	Depart to Holiday Inn Chiang Mai	UNISERV
18.30-20.00	<b>Dinner Reception</b>	River Terrace Restaurant, Holiday Inn Hotel Chiang Mai

### Saturday, February 11, 2017

Time	Schedule	Venue
	<b>Panel Session III</b>	
08.30-10.00	Politics and Policy in Asia	Room 1 - Fueng Fah (2 <sup>nd</sup> Flr.)
	Policy Paradigms in Socio-Technical Systems: Transport, Energy, Economy	Room 2 - Phuang Saet (2 <sup>nd</sup> Flr.)
	Expert review: Master of Public Policy at CMU (invitees only)	Room 3 - Phuang Kram (2 <sup>nd</sup> Flr.)
10.00-10.30	Coffee Break & Networking	1 <sup>st</sup> Flr.
	<b>Panel Session IV</b>	
10.30-12.00	Social Policy Over a Lifespan: Children's Health, Education, and Aging	Room 1 - Fueng Fah (2 <sup>nd</sup> Flr.)
	Policy Implementation: Corruption, Trust and Efficiency	Room 2 - Phuang Saet (2 <sup>nd</sup> Flr.)
	Policy Evaluation	Room 3 - Phuang Kram (2 <sup>nd</sup> Flr.)
12.00-13.00	Lunch	1 <sup>st</sup> Flr.
13.00-14.30	<b>Plenary: Public Policy Pedagogy</b> Chair: Scott Valentine   <i>National University of Singapore</i> <b>The Complex Adaptive Classroom</b> Scott Valentine   <i>National University of Singapore</i> <b>Co-design and delivery of postgraduate programs: an ANZSOG and LKY School collaboration</b> Peter Debus   <i>The Australia and New Zealand School of Government.</i> <b>Knowledge, Politics and Pedagogical Challenges in Public Policy Studies</b> Tanvir Aejaz   <i>University of Delhi</i>	Room 4- Inthanin (1 <sup>st</sup> Flr.)
14.30-15.00	Coffee Break & Networking	1 <sup>st</sup> Flr.
	<b>Panel Session V</b>	
15.00-17.00	Local Governance (II): Capacity Issues	Room 1 - Fueng Fah (2 <sup>nd</sup> Flr.)
	Policy Transfer: Diffusion and Best Practices	Room 2 - Phuang Saet (2 <sup>nd</sup> Flr.)
	The Roles of Environmental Narratives in Public Policy	Room 3 - Phuang Kram (2 <sup>nd</sup> Flr.)
17.00-17.20	<b>Closing Remark</b>	Room 4 - Inthanin (1 <sup>st</sup> Flr.)
17.20-18.30	<b>Organizational Meeting AP-PPN (members only)</b>	Room 4 - Inthanin (1 <sup>st</sup> Flr.)



Download Abstract | [www.pol.cmu.ac.th/apppn2017](http://www.pol.cmu.ac.th/apppn2017)

# Panel Details

## Panel Session I

Friday, February 10, 2017 10.30-12.30

### **Room 1 – Inthanin, 1<sup>st</sup> Flr.**

#### **Trends in Public Administration: Justice, Leadership, Collaboration and Good Governance**

**Chair:** Ora-orn Poocharoen | Chiang Mai University

**Discussant:** Zhilin Liu | Tsinghua University

*Formulating Good Governance and Moving Forward: Navigating Transparency or Reinforcing Authority and Power?*

Loo-See Beh | University of Malaya

*Organizational Changes in the Australian Public Service: What about Justice?*

Jeannette Taylor | University of Western Australia

*Deterring Prosocial People from Entering the Public Sector? Adverse Selection in the East Asian Public Service Exam*

Chung-An Chen | Nanyang Technological University

Don-Yun Chen | National Chengchi University

Zhou-Peng Liao | Open University

*Who Sets the Policy Agenda? Anti-corruption Policies in Thailand*

Mergen Dyussenov | National University of Singapore

### **Room 2 - Fai Kham, 1<sup>st</sup> Flr.**

#### **International Relations and Foreign Policy in East Asia: Trans-Boundary Issues**

**Chair:** Darryl Jarvis | The Education University of Hong Kong

**Discussant:** Catherine Althaus | University of Melbourne

*Understanding the Chinese One-Belt-One-Road: Cambodia Development on the Project*

Ngorn Kimhong | Xiamen University

*Characterizing Triangular Cooperation: The model of Thai-German-Lao and Thai-German- Vietnamese Partnerships*

Chirada Na Suwan | Mae Fah Luang University and Thammasat University

*Government Intervention and Innovation Dynamics: A Comparison of Singapore and Hong Kong*

Jue Wang | Nanyang Technological University

*Role of Third Party in Public Policy Making in Developing Countries in the Context of India*

M. Venkat Ram Reddy | Pandit Deendayal Petroleum

Neha Agarwal | University of Petroleum and Energy Studies

# Panel Session II

Friday, February 10, 2017 13.30-15.00

## Room 1 – Inthanin, 1<sup>st</sup> Flr.

### Environmental Policy in Asia: Evaluation and Improvements

**Chair:** Xun Wu | Hong Kong University of Science and Technology

**Discussant:** Andi Luhur Prianto, Muhammadiyah University of Makassar, Indonesia.

*Changing Policy-Making Negatively: Local Environmental Protests Apply to Local Government*

Zhi-Jun Yang | Guizhou University

*Policy Analysis on Conditions of Environmental Governance*

Dong Ae Shin | University of Kitakyusyu

*The Association of Ambient Fine Particulate Matter with Infant Mortality, Child Acute Respiratory Infection, and Child Anthropometric Failure in Bangladesh: Pooled Cross- Sectional Evidence from the Demographic and Health Surveys 2004, 2007, and 2011*

Nihit Goyal | National University of Singapore

*Self- Sustainable Socio- Economic Program Of NGOs In Sindh- Provision Of Safe Drinking Water And Sanitation In Sindh*

Abdul Khaliq Panhyar

## Room 2 - Fai Kham, 1<sup>st</sup> Flr.

### Local Governance (I): Networks and Collaboration

**Chair:** Loo-See Beh | University of Malaya

**Discussant:** Muhammad Shakil Ahmad | COMSATS Institute of Information Technology

*Inter-local Collaboration Mechanism in Korea and Institutional Collective Action Framework*

Hyung Jun Park | Sungkyunkwan University

Ji Ye Ju | Sungkyunkwan University

Boem Jun Park | Sungkyunkwan University

Jihyung Lee | Sungkyunkwan University

*Decoding Local Policy in Thailand: The Emergence of Policy Networks and Their Collaboration*

Piyapong Boossabong | Mahasarakham University

Pobsook Chamchong | Mahasarakham University

*Political Economy of Identities: Networking Strategies of Thai Yunnanese Transnational Entrepreneurs in Chiang Mai*

Lee Kian Cheng | Chiang Mai University, Thailand

*From periphery to center: Local government and the emergence of universal healthcare in Indonesia*

Diego Fossati | Griffith University

## Room 3 - Bua Thong, 1<sup>st</sup> Flr.

### Business and Policy

**Chair:** Richard Walker | City University of Hong Kong

**Discussant:** Alfred WU | The Education University of Hong Kong

*Ease Of Licensing Policy for Micro, Small, Medium Enterprises in Bantul Regency to Confront ASEAN Economic Community*

Talitha Andwi Aswari | Muhammadiyah Yogyakarta University

Riska Sarofah | Muhammadiyah Yogyakarta University

Siti Hidayatul Juma'ah | Muhammadiyah Yogyakarta University

*An Assessment of the Performance of the National Commission for Culture and the Arts in Preserving the Cultural Heritage Sites of the Philippines: The cases of Basilica of Saint Martin Tours in Taal, San Antonio de Padua Parish Church in Pila, and Barasao Church in Malolos*

Katrina Isabel Trillana | University of the Philippines Diliman

Asher Grace Cruz | University of the Philippines Diliman

Elisha Anne Del Rosario | University of the Philippines Diliman

Kevin Macarius Florentin | University of the Philippines Diliman

Nicole Anne Kahn Parreno | University of the Philippines Diliman

Roselyn Agojo Santiago | University of the Philippines Diliman

*No Excessive Profit Is Forever: Cadre Promotion Mechanism in China Revisited*

Ciqi Mei | Tsinghua University

Xiaozhen Zhai | Tsinghua University

*Exploring the impact of accounting standards convergence on enterprise behaviors --- Evidence from publicly listed companies in China*

Dan Yang | Beijing Normal University

# Panel Session III

Saturday, February 11, 2017 08.30-10.00

## **Room 1 – Fueng Fah, 2<sup>nd</sup> Flr.**

### **Politics and Policy in Asia**

**Chair: Jeannette Taylor | University of Western Australia**

**Discussant: Ciqi Mei | Tsinghua University**

#### *Barriers to Empowerment: Assessment of Community-led Local Development Organizations*

Muhammad Shakil Ahmad | COMSATS Institute of Information Technology

#### *The Swing of Public Opinion on Nuclear Energy: A Field Experiment in Hong Kong*

Tin Fai Kwok | The Chinese University of Hong Kong

Chung Hang Yeung | The Chinese University of Hong Kong

Yuan Xu | the Chinese University of Hong Kong

#### *Increasing Executive Leadership in National Departments*

Evan Berman | Victoria University of Wellington

#### *Examining the Impact of Citizen Participation in the Collaborative Policy and Service Delivery: Case of Direct Citizen Participation Platforms from Five Countries*

Khasan Redjaboev | National University of Singapore

Azizbek Marakhimov | Dongguk University

## **Room 2 - Phuang Saet, 2<sup>nd</sup> Flr.**

### **Policy Paradigms in Socio-Technical Systems: Transport, Energy, Economy**

**Chair: Louis Lebel, Chiang Mai University**

**Discussant: Leong Ching | National University of Singapore**

#### *Economic Policy Shifts in the Homelands of the Dragon and the Elephant*

Abu Bakkar Siddique | National University of Singapore

#### *Constructing and Deconstructing the Transport Infrastructure Policy Paradigm*

Anthony Perl | Simon Fraser University

Moshe Givoni | Tel Aviv University

#### *Implementing China's Food Safety Regulatory Reform: A Policy Capacity Perspective*

Wai-Hang Yee | The University of Hong Kong

Peng Liu | Renmin University of China

Liyun Wang | London School of Economics and Political Science

#### *Has the Centralized Environmental Governance Regime Worked in China?*

Wanxin Li | City University of Hong Kong



# Panel Session IV

Saturday, February 11, 2017 10.30-12.00

## Room 1 – Fueng Fah, 2<sup>nd</sup> Flr.

### Social Policy over a Lifespan: Children's Health, Education, and Aging

**Chair:** M. Ramesh | National University of Singapore

**Discussant:** John Walsh | Shinawatra University

#### *Governing Through Education*

Fabio Calzolari | Mae Fah Luang University

#### *Civic Education: Political Development Council towards Public Policy*

Somkait Nakatok | King Prajadhipok's Institute

#### *Political and Fiscal Determinants of Infant and Child Health: A Comparative Analysis of Southeast Asian Countries*

Tatchalerm Sudhipongpraacha | Thammasat University

#### *Who Will Pay? A Framework to Create Fiscal Space to Pay for Age-Related Spending.*

Azad Singh Bali | National University of Singapore and Murdoch University

## Room 2 - Phuang Saet, 2<sup>nd</sup> Flr.

### Policy Implementation: Corruption, Trust and Efficiency

**Chair:** Anthony Perl | Simon Fraser University

**Discussant:** Itzhak Galnoor | Hebrew University

#### *Corruption and Trust in Government: Evidence from China*

Yiping Wu | Shanghai University of Finance and Economics

Alfred M. Wu | The Hong Kong Institute of Education

#### *Emergency Management in China: Towards A Comprehensive Model?*

Xiaoli Lyu | Tsinghua University

#### *Public-Private Partnership in Water Sector in China*

Xun WU | Hong Kong University of Science and Technology

Neng Qian | National University of Singapore;

Schuyler House | World Bank

Alfred Wu | The Education University of Hong Kong

#### *Gender Segregation on Orthodox Buses – a Time Considerations Perspective: The Case of the Israeli High Court of Justice ruling on the "Segregation Lines" 2011*

Assaf Meydani | The Academic College of Tel-Aviv Yaffo

## Room 3 - Phuang Kram, 2<sup>nd</sup> Flr.

### Policy Evaluation

**Chair:** Christel Arnaud Ngadima, University of the Philippines

**Discussant:** Patamawadee Jongruck | Chiang Mai University

#### *Administrative Reforms and Policy Capacity in Asia: An Analysis of ADB's Public Sector Management Projects*

Kidjie Saguin | National University of Singapore

#### *Performance Information Use: Experimental Evidence on Performance Dimensions, and Data Sources, Types and Information*

Richard M. Walker | City University of Hong Kong

M. Jin Lee | City University of Hong Kong, Hong Kong

Oliver James | University of Exeter

Samuel Ho | City University of Hong Kong

#### *Health and Mental Health Effects of Local Immigration Enforcement Policies on Latino Immigrants in the US*

Julia Shu-Huah Wang | University of Hong Kong

Neeraj Kaushal | Columbia University

#### *The Impact of the Internet Penetration on Income Inequality in Asia*

Rachaphum Panichsombat | National University of Singapore

# Panel Session V

Saturday, February 11, 2017 08.30-10.00

## Room 1 – Fueng Fah, 2<sup>nd</sup> Flr.

### Local Governance (II): Capacity Issues

**Chair:** Azad Singh Bali, LKYSP, NUS and Murdoch University

**Discussant:** Piyapong Boossabong, Mahasarakham University, Thailand

*Understanding the gradual paradigmatic shift of community based ecotourism in Chiang Mai and a policy proposal to strengthen its governance*

Rajesh Rangarajan | National University of Singapore

Vijay Krishna | National University of Singapore

Nguyen Quy Tam | National University of Singapore

*Collaborative Governance in Local Welfare Delivery: Challenges and Prospects in the North of Thailand*

Chatthip Chaichakan | University of Phayao

Dararat Khampeng | University of Phayao

*Urbanization and Its Discontent in Thailand's Emerging University Town*

Chatthip Chaichakan | University of Phayao

Dararat Khampeng | University of Phayao

Nisachon Prommarin | University of Phayao

Pirin Khadthipong | University of Phayao

Nattaree S. Pongpipat | University of Phayao

Piyawadee Rohitarachoon | University of Phayao

Panyupa Nopparak | University of Phayao

*No Where to Run: Local Government Capacity, Adaptive Policy and Climate Change Impacts in Makassar City, Indonesia*

Andi Luhur Prianto | Muhammadiyah University of Makassar

## Room 2 - Phuang Saet, 2<sup>nd</sup> Flr.

### Policy Transfer: Diffusion and Best Practices

**Chair:** Hyung Jun Park | Sungkyunkwan University

**Discussant:** Evan Berman | Victoria University of Wellington

*Diffusion of CCTs from Latin America to Asia: The Philippine 4P case*

M Ramesh | National University of Singapore

Kidjie Seguin | National University of Singapore

Michael Howlett | National University of Singapore

*Governance of Economic Spatial Initiatives*

John Walsh | Shinawatra University

*Governance Challenges in Replicating Best Practices and Policy Changes: The Canaan Farm Experience in the Philippines.*

Christel Arnaud Ngadima | University of the Philippines

*Soft Diplomacy or Hard Policy Benefits? Exploring the value of cross-jurisdictional learning exchanges in policy and public administration across the Asia-Pacific region*

Catherine Althaus | University of Melbourne and ANZOG

## Room 3 - Phuang Kram, 2<sup>nd</sup> Flr.

### The Roles of Environmental Narratives in Public Policy

**Chair:** Dong Ae Shin | University of Kitakyusyu

**Discussant:** Wai-Hang Yee | The University of Hong Kong

*Policy Translation in the Mekong River Basin*

Leong Ching | National University of Singapore

*Road to Shared Prosperity: The Elaboration and Influence of a Transboundary Policy Narrative for Regional Economic Integration*

Louis Lebel | Chiang Mai University

Boripat Labell | National University of Singapore

*The Influence of Nexus Narratives on the Governance of Transboundary Water Resources in the Mekong Region*

Louis Lebel | Chiang Mai University and National University of Singapore

*Privatization and Outsourcing Policy: Can We Draw Boundaries between the Public and the Private?*

Itzhak Galnoor | Hebrew University

# USEFUL INFORMATION

## UNISERV PLAN

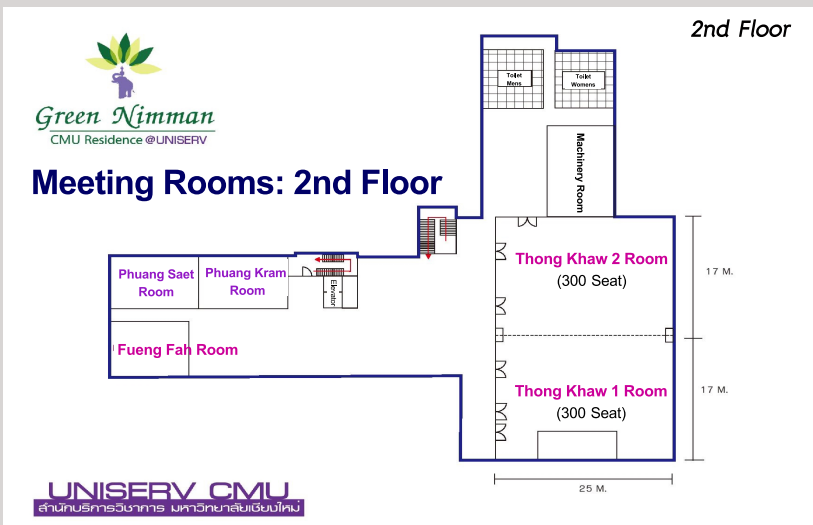
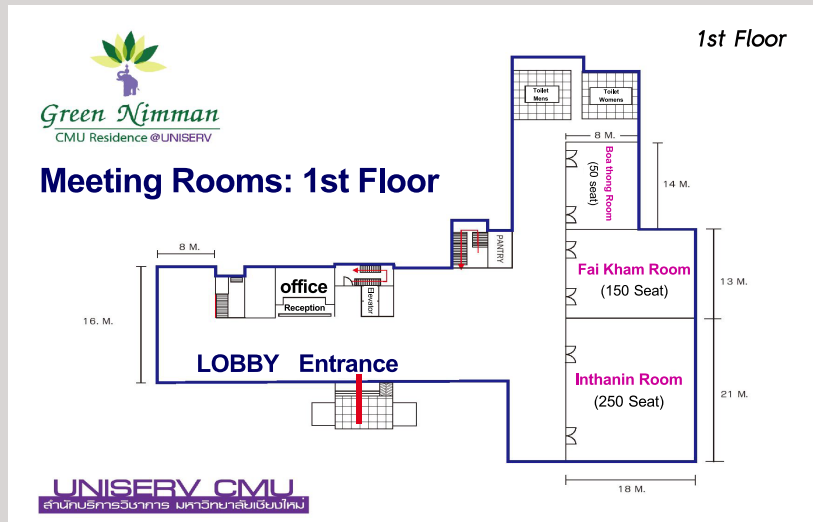

## Conference venue information

University Academic Service Center,  
Chiang Mai University (UNISERV CMU)  
239 Nimmanhemim Road, Mung Chiang Mai,  
50200, Thailand  
Tel.: +66-53-942881-4, +66-81-8826411

## Conference Wifi

UNISERV WIFI | Username: fs99nk  
Password: ga4r4c

## UNISERV map



[www.uniserv.cmu.ac.th/web59/php/contact.php](http://www.uniserv.cmu.ac.th/web59/php/contact.php)

## Emergency call

Emergency Call	191
Tourist Police	1155
Ambulance Service	1669
Sriphat Medical Center	+66-53-936900-1
Chiangmai Ram Hospital	+66-53-920300
Chiang Mai Taxi	+66-53-201307
Airport Taxi	+66-53-922128
UBER or GRAB Taxi provided through application	

## CMU Coordinators

1. Dr. Patamawadee Jongruck (Jan) +66 85 103 2010
2. Supheerutai Buakaew (Pui) + 66 83 56 765 91

